



ISO 9001 國際品質認證
ISO 9001 CERTIFICATE

松暉電機工業股份有限公司
SONG HUEI ELECTRIC CO., LTD.
佛山市松暉電機科技有限公司
FOSHAN SONG HUEI ELECTRIC CO., LTD.

| 1.一般事項 General | | |
|---|---|--|
| 項目 Item | 測試條件 Test Conditions | 規格 Performance |
| 1.1 額定值 Rating | DC 12 V 0.1 A | / |
| 1.2 接觸型式 Func tion | 2 P 2 T | / |
| 1.3 時間特性 Timing | Non-shorting | / |
| 2.電氣特性 Electrical Characteristics | | |
| 項目 Item | 測試條件 Test Conditions | 規格 Performance |
| 2.1 接觸電阻 Contact resistance | 在1 KHz 微小電流 (100 mA 以下)測試。 Measured at 1 KHz small current (100 mA or less) | 100 mΩ max 100 毫歐姆以下 |
| 2.2 絕緣電阻 Insulation resistance | 輸入DC 500 V 電壓1分鐘按以下接觸方法測試: (1)排腳相互之間 (2)排腳與外殼之間 A voltage of DC 500 V shall be applied for 1 min after which measurement be made (1) Between terminals (2) Between individual terminals and frame | 100 MΩ min 100兆歐以上 |
| 2.3 耐電壓 Dielectric strength | 輸入AC 500 V (50 HZ ~60 HZ)電壓,1分鐘感度電流為0.5 mA 按以下接觸方法測試: (1)排腳相互之間 (2)排腳與外殼之間 AC 500 V rms (50 HZ ~60 HZ) for 1 min trip current 0.5 mA (1) Between terminals (2) between individual terminals and frame | 沒有絕緣破壞等異常 Without damage to parts arcing or breakdown etc. |
| 3.機械性能 Mechanical Characteristics | | |
| 項目 Item | 測試條件 Test Conditions | 規格 Performance |
| 3.1 作動力 Operating force | / | 250 gf ± 100 gf |
| 3.2 端子強度 Terminal strength | 在任意一個方向的前端加 300 gf 力度測試, 時間為1分鐘。 A static load of 300 gf shall be applied to the tip of the terminal for 1 min in any direction | 在端子中沒有裂開、鬆動等異常、滿足於機械、電器性能 Electrical characteristics shall be satisfied without damage or excessive looseness of actuator |
| 3.3 測試標準狀態 Standard atmospheric condirions | 在沒有指定的情況下測試溫度、濕度、氣壓如下: (1) 溫度為 5 °C ~ 35 °C (2) 濕度為 45 % ~ 85 % (3) 氣壓為 80 Kpa ~ 106 Kpa Unless otherwise specified The standard range of atmospheric condmons for making measurements and tests are as follows: (1) Ambient temperature : 5 °C to 35 °C (2) Relative humidity : 45 % to 85 % (3) Alr pressure: 80 Kpa to 106 Kpa | |
| 3.4 使用溫度範圍 Practical temperature rang | 在-16 °C ~ +60 °C 溫度使用。 -16 °C ~ +60 °C | |
| 4.耐久性 | | |
| 項目 Item | 測試條件 Test Conditions | 規格 Performance |
| 4.1 壽命試驗 Life test | 無負荷: 操作者以每分鐘 20 次的頻率做 10, 000 回之次測試。 With out load : An actuator shall be subject to 10,000 cycles at a speed of 20 cycles per 1 min | (1) (接觸電阻) Contact resistance 500 mΩ max 500 毫歐以下。 (2)其它滿足於機械性能. 電氣性能。 Mechanical and electronical characteristics sahl be satisfied |
| 4.2 可焊性試驗 Soldera bility test | 端子頂部被浸入錫焊池中2 mm 深溫度為 230 ± 5 °C 時間為 3 ± 0.5秒。 The top of the terminals shall be dipped 2 mm in the solder bath of 230 ± 5 °C for 3 ± 0.5 seconds. | 焊接面積要有75 % 以上 The area of soldering should be over 75%. |



ISO 9001 國際品質認證
ISO 9001 CERTIFICATE

松暉電機工業股份有限公司
SONG HUEI ELECTRIC CO., LTD.
佛山市松暉電機科技有限公司
FOSHAN SONG HUEI ELECTRIC CO., LTD.

| 4.3 | 耐焊性試驗 Resistance to soldering heat test | <p>溫度及浸漬時間 Temperature and immersing time</p> <table border="1" data-bbox="459 336 1024 600"> <thead> <tr> <th></th> <th>溫度 (°C) Temperature</th> <th>時間 (S) Time</th> </tr> </thead> <tbody> <tr> <td>浸錫 Dip soldering</td> <td>260 ± 5</td> <td>3 ± 1</td> </tr> <tr> <td>手焊 Manual soldering</td> <td>360 ± 10</td> <td>3 ± 1</td> </tr> </tbody> </table> <p>浸錫深度: 浸錫深度至基板PCB表面, 基板厚度為1.6mm (2)Immersion depth: Immersion depth up to the surface of the boars thickness of printed wiring board 1.6 mm</p> | | 溫度 (°C) Temperature | 時間 (S) Time | 浸錫 Dip soldering | 260 ± 5 | 3 ± 1 | 手焊 Manual soldering | 360 ± 10 | 3 ± 1 | <p>本體無變形、能滿足於機械、電氣性能。 Without deformation of case or excessive looseness of teminals, electrical characteristics shall be satisfied .</p> |
|------------------------|--|---|--|------------------------|----------------|---------------------|---------|-------|------------------------|----------|-------|---|
| | 溫度 (°C) Temperature | 時間 (S) Time | | | | | | | | | | |
| 浸錫 Dip soldering | 260 ± 5 | 3 ± 1 | | | | | | | | | | |
| 手焊 Manual soldering | 360 ± 10 | 3 ± 1 | | | | | | | | | | |
| 4.5 | 耐冷試驗 Cold test | <p>放置在溫度-25 ± 3° C中96小時後, 再放置常溫常濕中1小時來進行測試。 The switch shall be stored at a temperature of -25 ± 3° C for 48 hours. Then the switch shall be maintained at standard atmospheric conditions for 1 hour after which measurement shall be made .</p> | <p>外觀無異常, 滿足於機械、電器性能。 There shall be no damage onappearance mechanical and electrocal characteristics shall be satisfied</p> | | | | | | | | | |
| 4.5 | 耐熱試驗 Heat test | <p>放置在溫度85 ± 2° C中 96 小時後, 再放置正常室溫中 1 小時來進行測試。 The switch shall be stored at a temperature of 85 ± 2° C for 96 hours .Then the switch shall be maintained at standard atmospheric conditions for 1 hour after which measurement shall be made .</p> | | | | | | | | | | |
| 4.4 | 潮濕試驗 Humidity test | <p>放置在溫度40 ± 2° C的相對濕度為 90 % ~ 95 %, 環境中96小時後, 再將樣版放在正常環境1小時後進行測試。 The switch shall be stored at a temperatue of 40 ± 2° C and a humidity of 90 % to 95 % for 96 hours .Then the switch shall be maintained at standard atmospheric condition measurement shall be made.</p> | | | | | | | | | | |

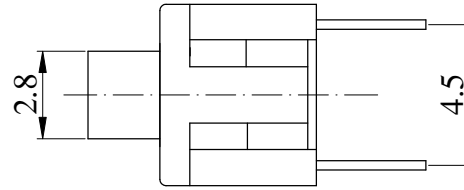
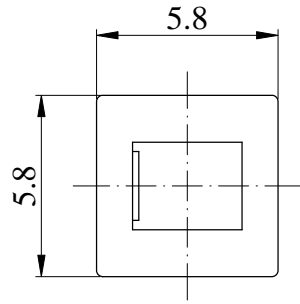

Mounting Hole

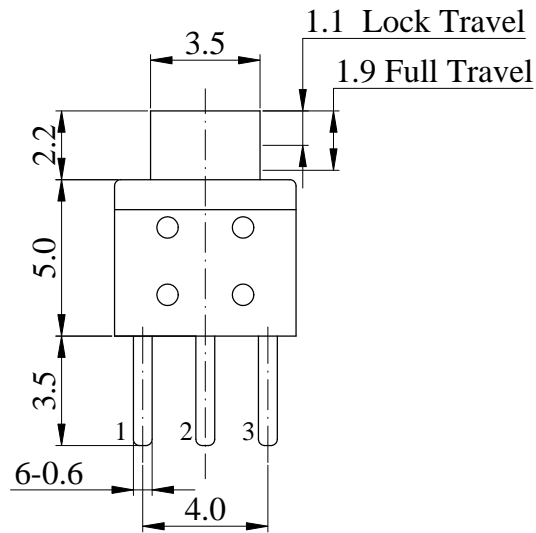
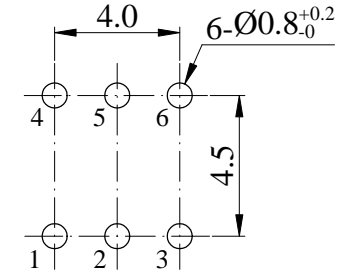

SCHEMATIC

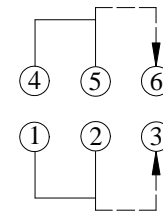

| Non notation tolerance | |
|------------------------|------|
| < 10 | ±0.3 |
| 10 ~ 100 | ±0.5 |
| > 100 | ±0.8 |



SONG HUEI ELECTRIC CO., LTD.
FOSHAN SONG HUEI ELECTRIC CO., LTD.

MODEL: PS22E65/LOCK/0245

Approval



Checked



Projected



UNIT

mm

SCALE

5:1

VERSION

1.1

DATE

2018.07.23

DRAWING NO.

SS-086

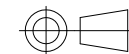

ISSUE

整理图元

何鴻根

2019.01.07

SUBJECT

NAME

DATE

RECORD