

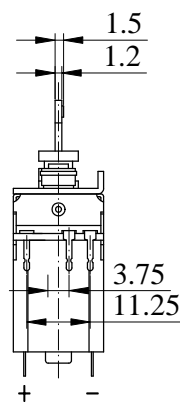

ISO 9001 國際品質認證  
ISO 9001 CERTIFICATE

松暉電機工業股份有限公司  
SONG HUEI ELECTRIC CO., LTD.  
佛山市松暉電機科技有限公司  
FOSHAN SONG HUEI ELECTRIC CO., LTD.

一般事項 General			
使用溫度範圍 Operating temperature	-10 °C ~ +60 °C		
儲存溫度 Storage temperature	-20 °C ~ +80 °C		
重量 Weight	SL6071M	SL6072M	SL10071M
	65 g max		90 g max
電氣特性 Electrical Characteristics			
總阻值 (R) Total resistance	10 KΩ ~ 100 KΩ		
總阻值容許誤差 Total resistance tolerance	± 20 %		
阻值線性 Resistance taper	B: Liner Taper ( servo track ) Touch sence track		
摺動雜音 Sliding noise	Less than 100mV		
定格電力 Rated power (W)	0.2 W		
殘留阻值 Residual resistance	Less than 30 Ω		
額定電壓 Rated voltage (V)	$E = \sqrt{P * R}$ E: Rated voltage 額定電壓 (V) P: Power rating 額定電力 (W) R: Nominal total resistance 公稱全阻抗值 (Ω) 當額定電壓超過最高使用電壓的時候，最高使用電壓即為額定電壓。 When the rated voltage exceeds the maximum operating voltage, the maximum operating voltage shall be the rated voltage.		
絕緣阻抗 Insulation resistance	More than 50 MΩ at DC 100 V		
機械特性 Mechanical Characteristics			
滑動行程 Travel length	<input type="checkbox"/> 60 mm ± 0.5 mm	<input type="checkbox"/> 100 mm ± 0.5 mm	
面板之安裝孔距 Mounting centres	<input type="checkbox"/> 80 mm ± 0.5 mm	<input type="checkbox"/> 120 mm ± 0.5 mm	
滑動力距 Operating force	30 ~ 50 gf.cm		
作動止強度 Stopper strength	10 Kgf.cm max		
柄的晃動 Lever wobble	2 ( 2 x L ) / 25 mm max		
柄的偏心度 (單側) Lever deviation	0.5 mm max		
軸推拉強度 Shaft push-pull strength	5 Kgf max		
滑動壽命 Sliding life	100,000 cycles		
馬達特性 Motor Performance ( 8 V DC Motor )			
啟動電流 Starting current	500 mA max		
使用電壓 Operating voltage	DC 5 ~ 11 V		
馬達回應時間 Motor response time	<input type="checkbox"/> 60 mm travel	<input type="checkbox"/> 100 mm travel	
	<input type="checkbox"/> 80 msec max	<input type="checkbox"/> 100 msec max	

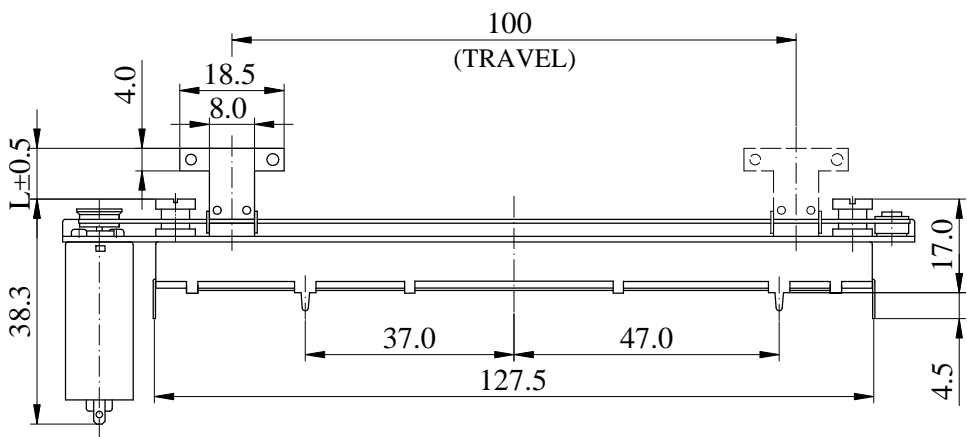
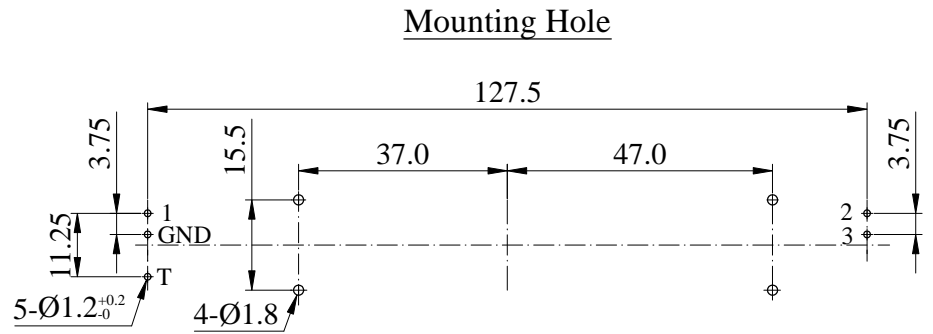
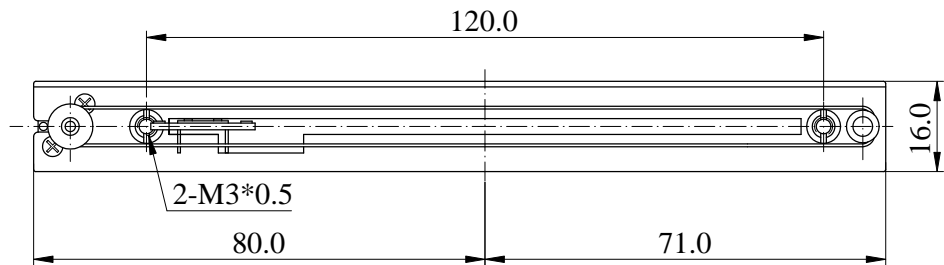

### CIRCUIT

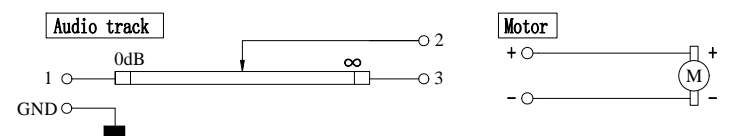

### Touch sense track

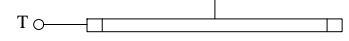

### TERMINAL STYLE

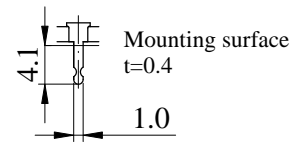

		Non notation tolerance	
		< 10	±0.3
L=	9	10 ~ 100	±0.5
choose		> 100	±0.8

**S**® SONG HUEI ELECTRIC CO., LTD.  
FOSHAN SONG HUEI ELECTRIC CO., LTD.

MODEL: SL10071M(H)/M

Approval	Checked	Projected

UNIT	mm	SCALE	1:1.5
VERSION	1.1	DATE	2013.01.10
DRAWING NO.	SLV7-004		

	整理图元	何鸿根	2019.01.04
ISSUE	SUBJECT	NAME	DATE
RECORD			